

REPLACEMENT OF FLOORING BOARDS

FOR THE NAILED, STAPLED OR GLUED INSTALLATION

INDIVIDUAL WOOD FLOORING BOARDS CAN BE REPAIRED/REPLACED IN SOLID OR ENGINEERED PRODUCTS WITHOUT AFFECTING ADJOINING BOARDS. ALWAYS CHECK THE SPECIES TO INSURE A PROPER MATCH. PREFINISHED BOARDS SHOULD BE SELECTED FOR GLOSS AND COLOR MATCH.

REMOVING THE PLANK OR STRIP ON WOOD AND CONCRETE SUBFLOORS

- Make sure you have a replacement board.
- Set a circular saw to the depth of the thickness of the board to be removed. Make one cut inset 1/2 in (1.3 cm) from groove side running from end to end on the board to be removed.
- Make a second cut inset 1/2 in (1.3 cm) from tongue side running from end to end on the board to be removed.
- Make a third cut across the center of the board at a 30-45° angle from first long cut to second long cut.
- With a chisel cut completely through both ends at cut lines and lift out center of the board. The groove side piece can now be easily removed.
- Carefully remove nails or staples and side tongue piece. Avoid damage to adjoining boards.

REPLACING FLOORING THAT HAS BEEN NAILED/STAPLED DOWN

- Clean all debris from the area.
 - Measure the opening and cut replacement board to size.
 - Carefully test the new board against the opening for precise fit.
 - From the back side of the replacement board, cut lower half of its groove side and end match with a table saw so that it will fit over the tongue of the adjoining boards in the replacement area.
 - Apply strips of adhesive 6 in (15 cm) apart to the back of the replacement board or to the subfloor.
- Use a polyurethane adhesive so the board can expand and contract. Do not use carpenter's glue.

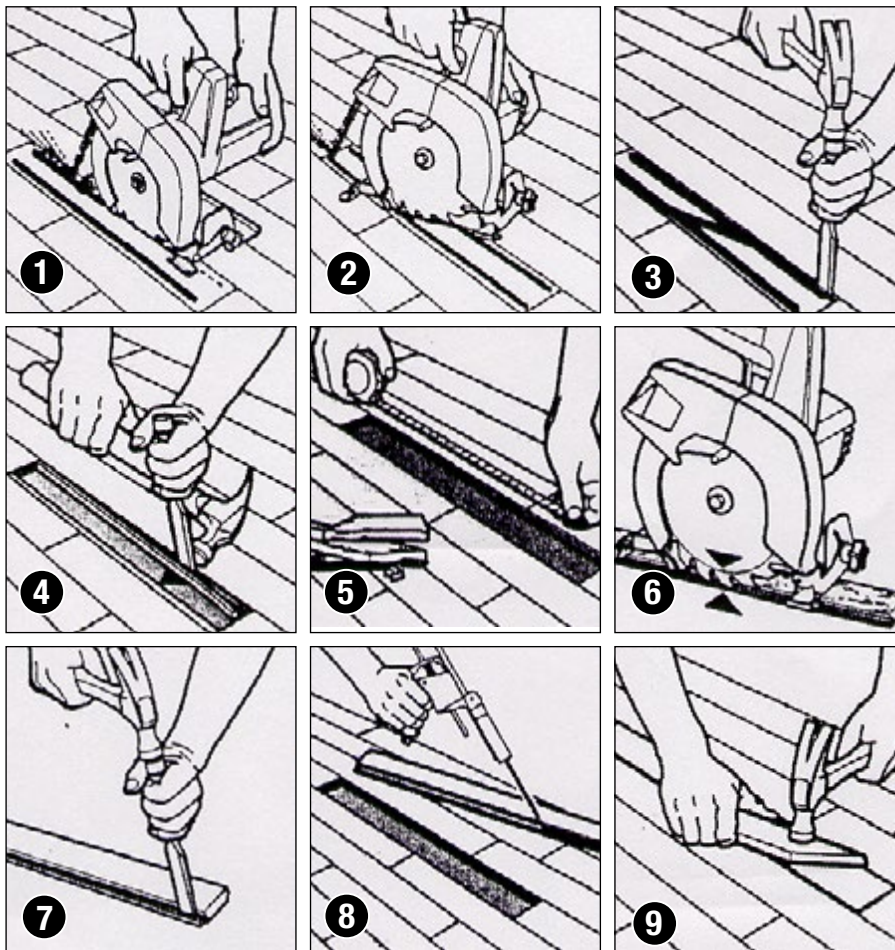

REPLACING FLOORING THAT HAS BEEN GLUED DOWN.

- Clean all debris and old adhesive from the work area. Repair subfloor if necessary.
 - Measure the opening and cut replacement board to size.
 - Carefully test the new board against the opening for precise fit.
 - From the back side of the replacement board, cut lower half of its groove side and end match with a table saw so that it will fit over the tongue of the adjoining boards in the replacement area.
 - Apply strips of adhesive 6 in (15 cm) apart to the back of the replacement board or to the subfloor.
- Use a polyurethane adhesive so the board can expand and contract. Do not use carpenter's glue.